

Внутреннее устройство системного блока

Лекцию подготовил
преподаватель
Тукубаев А.С.

001

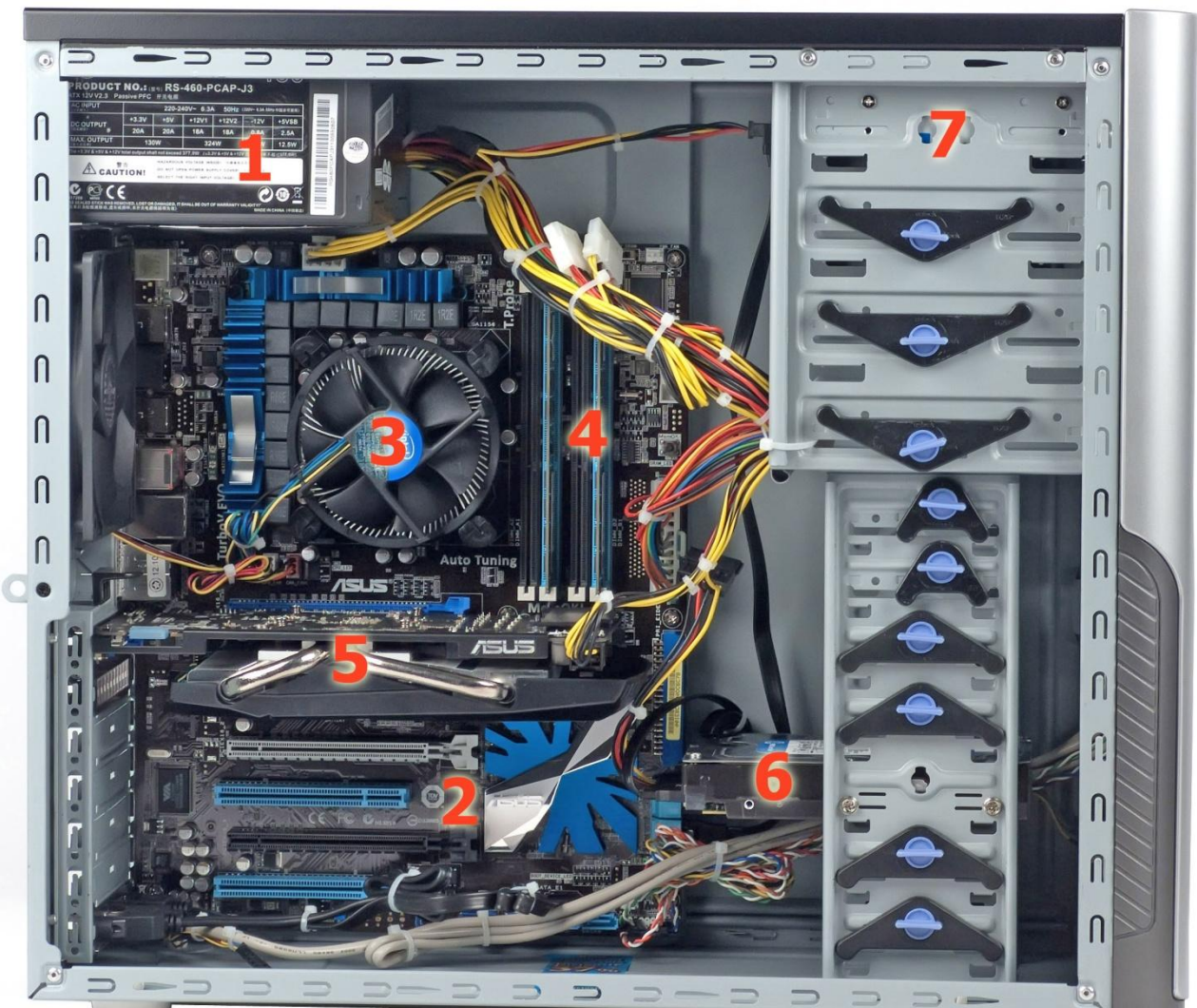

PRODUCT NO.: (型号) RS-460-PCAP-J3

ATX 12V V2.3 Passive PFC 开关电源

DC OUTPUT (DC输出)	+3.3V	+5V	+12V1	+12V2	-12V	+5VSB
MAX. OUTPUT (最大输出)	20A	20A	18A	18A	0.8A	2.5A
	130W	324W				12.5W

The +3.3V & +5V & +12V total output shall not exceed 377.0W. (+3.3V & +5V & +12V)

CAUTION! 警告! HAZARDOUS VOLTAGE. (警告: 有电危险) DO NOT OPEN POWER SUPPLY COVER. (请勿打开电源供应器盖) SELECT THE RIGHT INPUT VOLTAGE. (请选择正确的输入电压)

CE, RoHS, and other regulatory marks. MADE IN CHINA (中国制造)

1

7

4

3

002

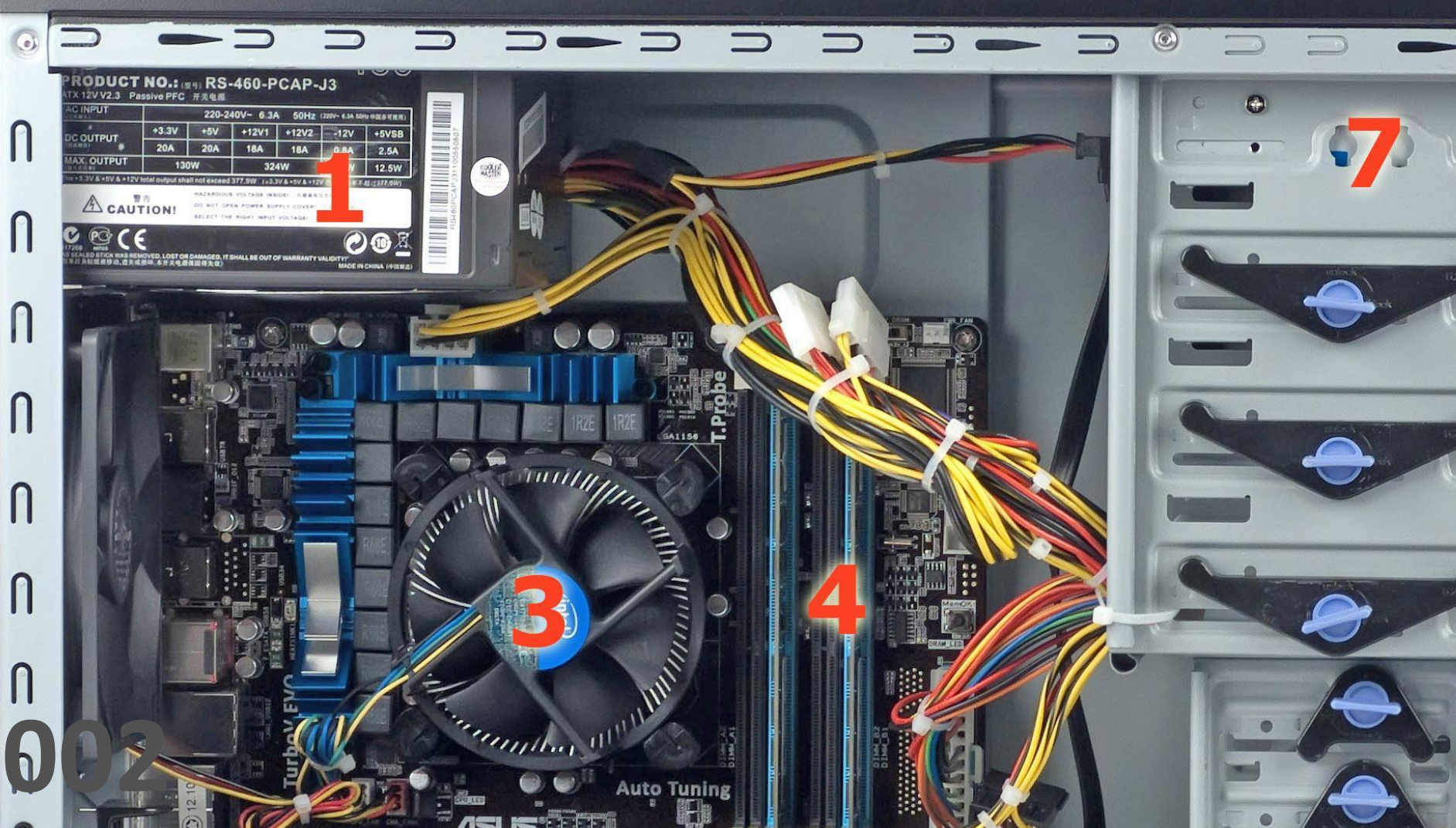

PRODUCT NO.: (型号) RS-460-PCAP-J3

ATX 12V V2.3 Passive PFC 开关电源

AC INPUT (输入)	220-240V~ 6.3A 50Hz (220V~6.3A 50Hz 中国专用标准)					
DC OUTPUT (输出)	+3.3V	+5V	+12V1	+12V2	-12V	+5VSB
	20A	20A	18A	18A	0.8A	2.5A
MAX. OUTPUT (最大输出)	130W		324W		12.5W	

*The +3.3V & +5V & +12V total output shall not exceed 377.0W. (+3.3V & +5V & +12V)

CAUTION! 警告! HAZARDOUS VOLTAGE. (警告: 有电危险!) DO NOT OPEN POWER SUPPLY COVER. (请勿打开电源供应器盖.) SELECT THE RIGHT INPUT VOLTAGE.

CE 17260 100% RECYCLED MATERIALS 100% 再生材料
IF SEALED STICK WAS REMOVED, LOST OR DAMAGED, IT SHALL BE OUT OF WARRANTY VALIDITY!
若封条被移除、遗失或损坏，本产品将不在保修范围内。
MADE IN CHINA (中国制造)



1

7

4

3

03

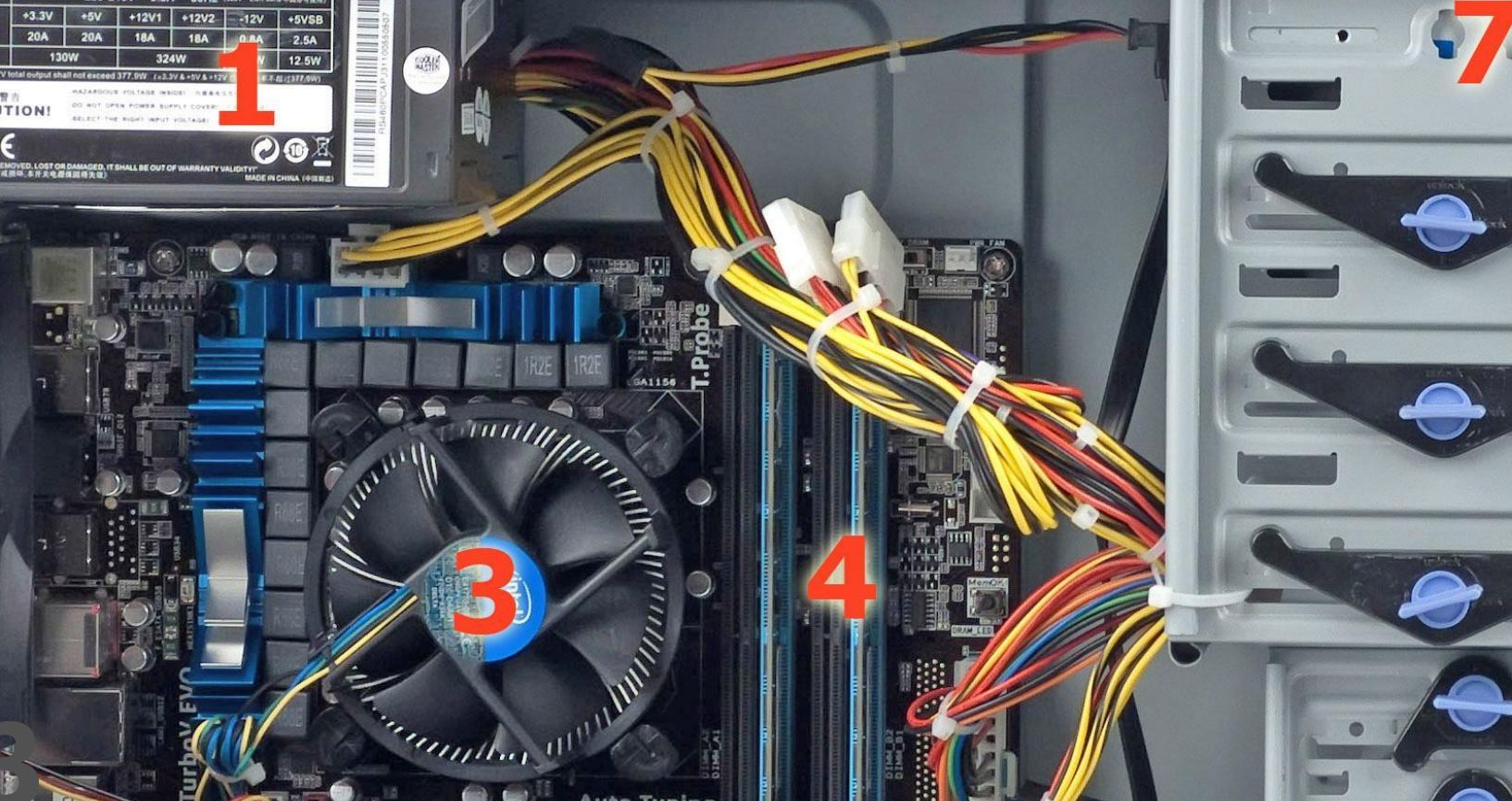

GIGABYTE™



Insist on **Ultra Durable**

Designed for Overclocking
AMD A-Series APUs and for use
in Water Cooled Systems



Industry Leading 60A Rated Power Stage with
Lower Losses, Higher Efficiency and Excellent
Thermal Management



Ultra Durable™ Motherboard (Socket FM2)

F2A85X-UP4



DIGITAL POWER



Patent Pending
3D BIOS
Dual UEFI BIOS™



Humidity Protection

2X
Copper PCB
New Glass
Fabric PCB

OVERCLOCKERS.UA

**UNLOCKED
PERFORMANCE**

004

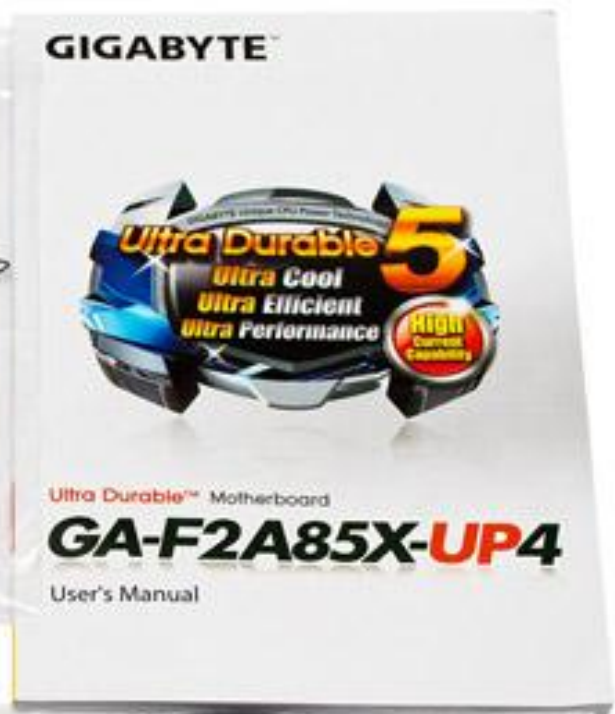

005



006

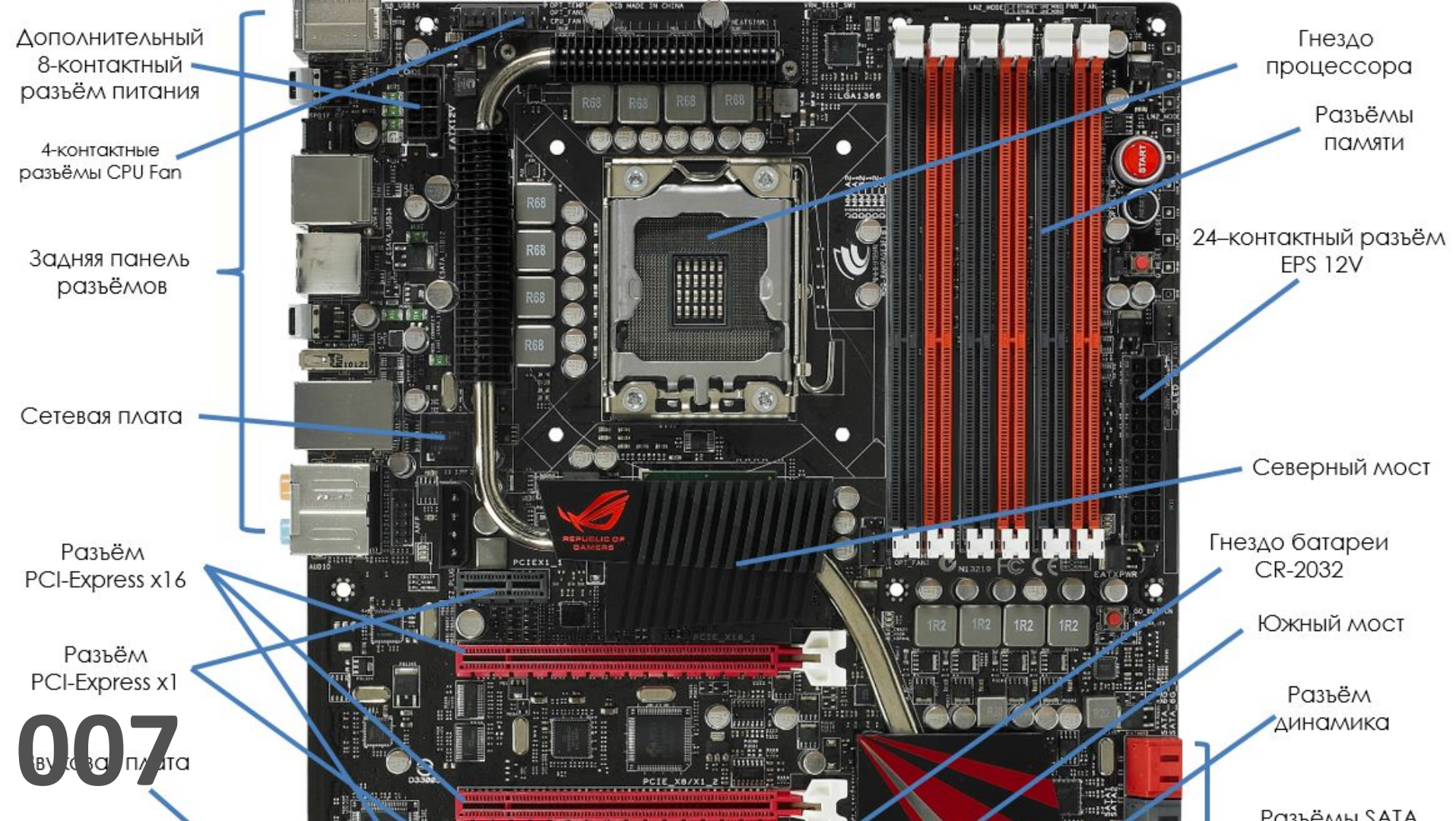

Дополнительный
8-контактный
разъем питания

4-контактные
разъемы CPU Fan

Задняя панель
разъемов

Сетевая плата

Разъем
PCI-Express x16

Разъем
PCI-Express x1

007
Видео плата

Гнездо
процессора

Разъемы
памяти

24-контактный разъем
EPS 12V

Северный мост

Гнездо батареи
CR-2032

Южный мост

Разъем
динамика

Разъемы SATA

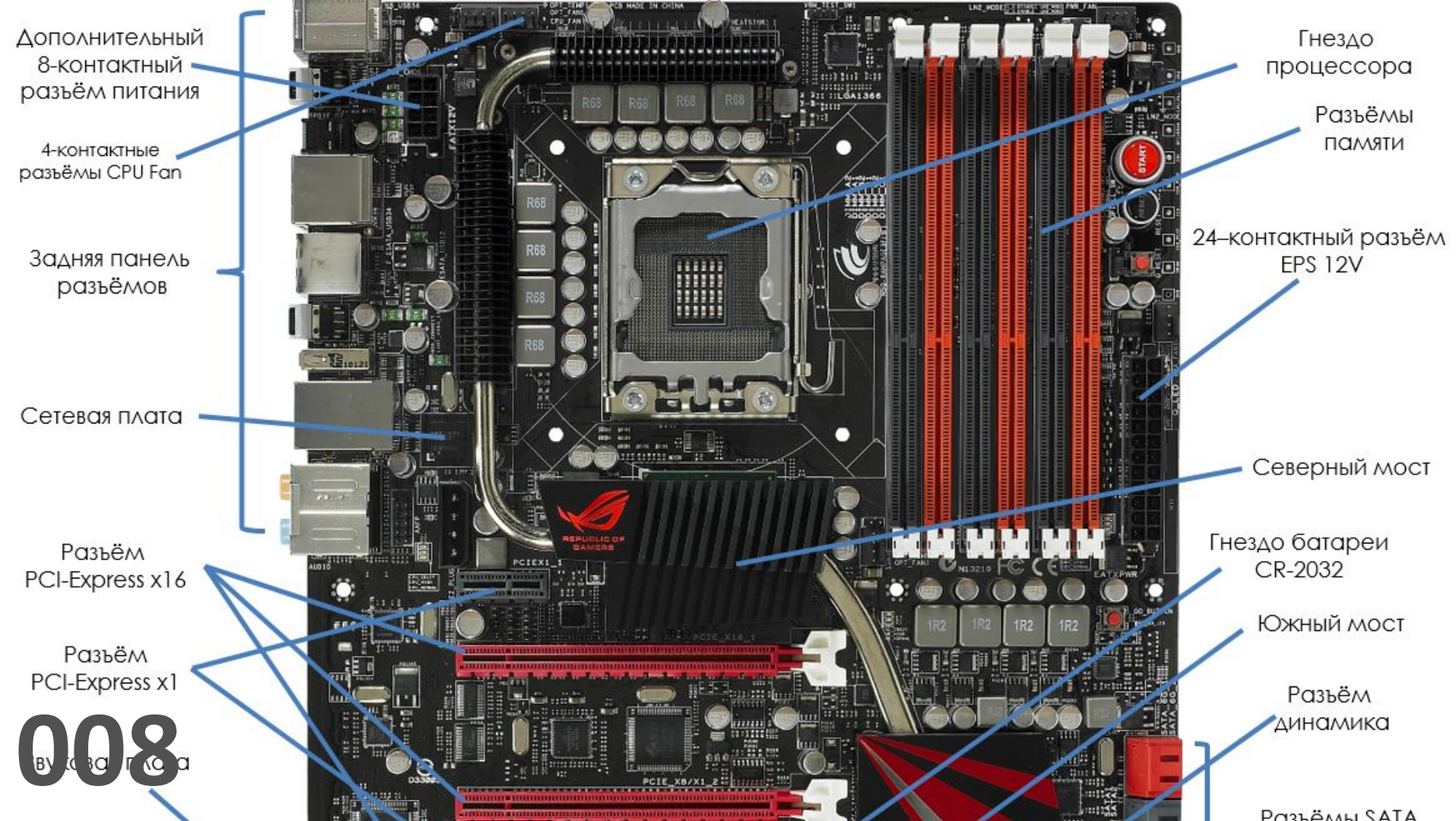

Дополнительный
8-контактный
разъем питания

4-контактные
разъемы CPU Fan

Задняя панель
разъемов

Сетевая плата

Разъем
PCI-Express x16

Разъем
PCI-Express x1

008
BY ZORBA.TKCSA

Гнездо
процессора

Разъемы
памяти

24-контактный разъем
EPS 12V

Северный мост

Гнездо батареи
CR-2032

Южный мост

Разъем
динамика

Разъемы SATA

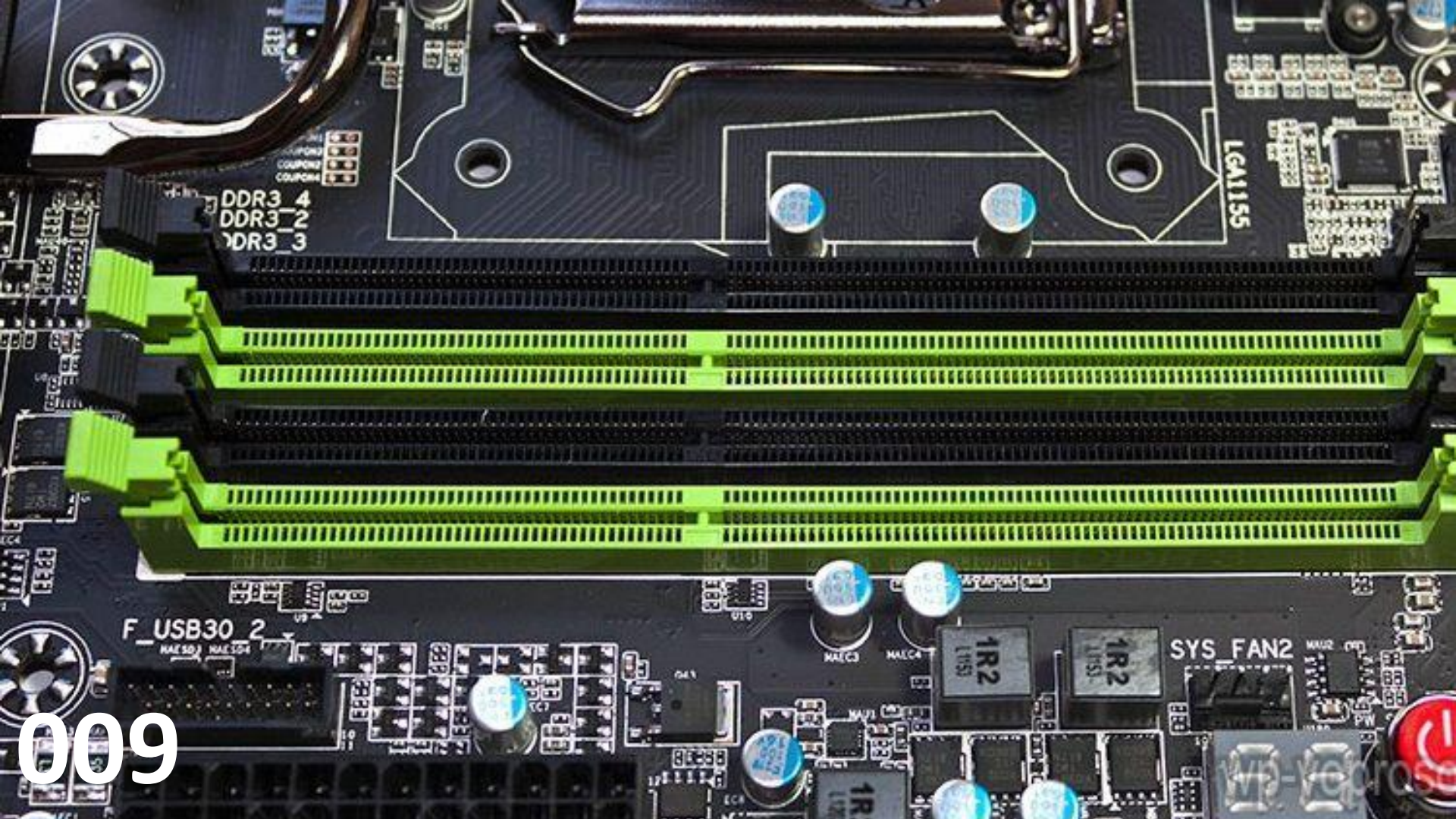

DDR3_4
DDR3_2
DDR3_3

LGA1155

F_USB30_2

SYS_FAN2

1R2

1R2

009

32-Bit vs 64-Bit Slots/Boards

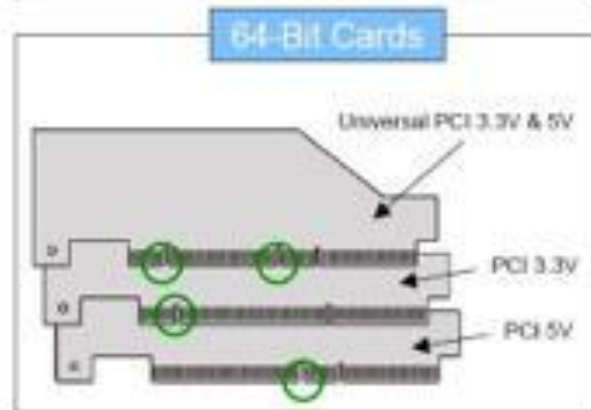
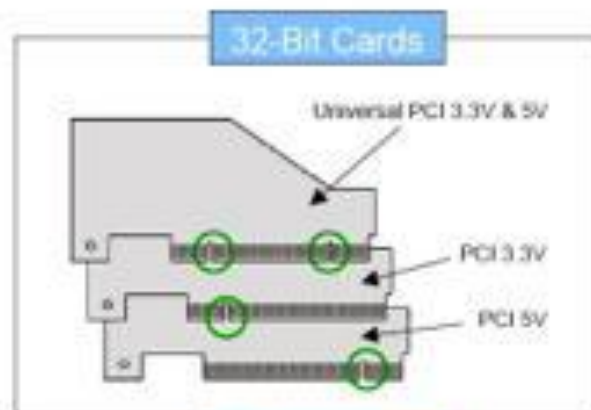
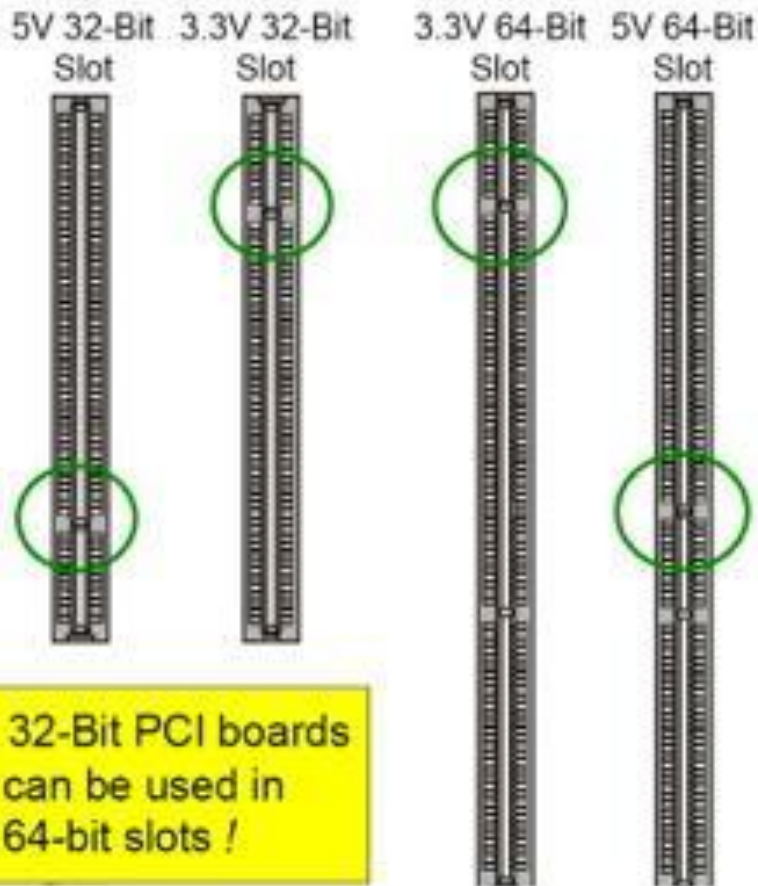

010

PCIe x 1



PCIe x 16



PCI



PCI



Phoenix BIOS™
D885 BIOS
Phoenix 1.0.0.0
275086455

011

012

AMCO

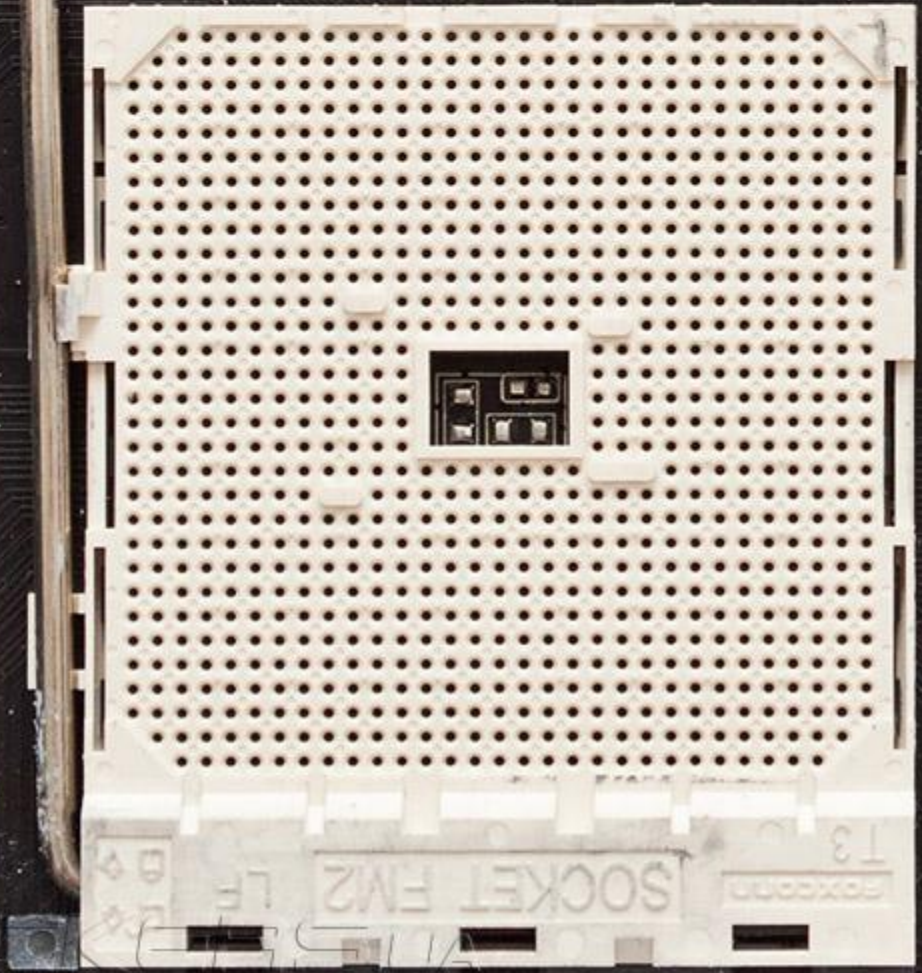

AMCO

SOCKET FM2
T3



013



014

021



022

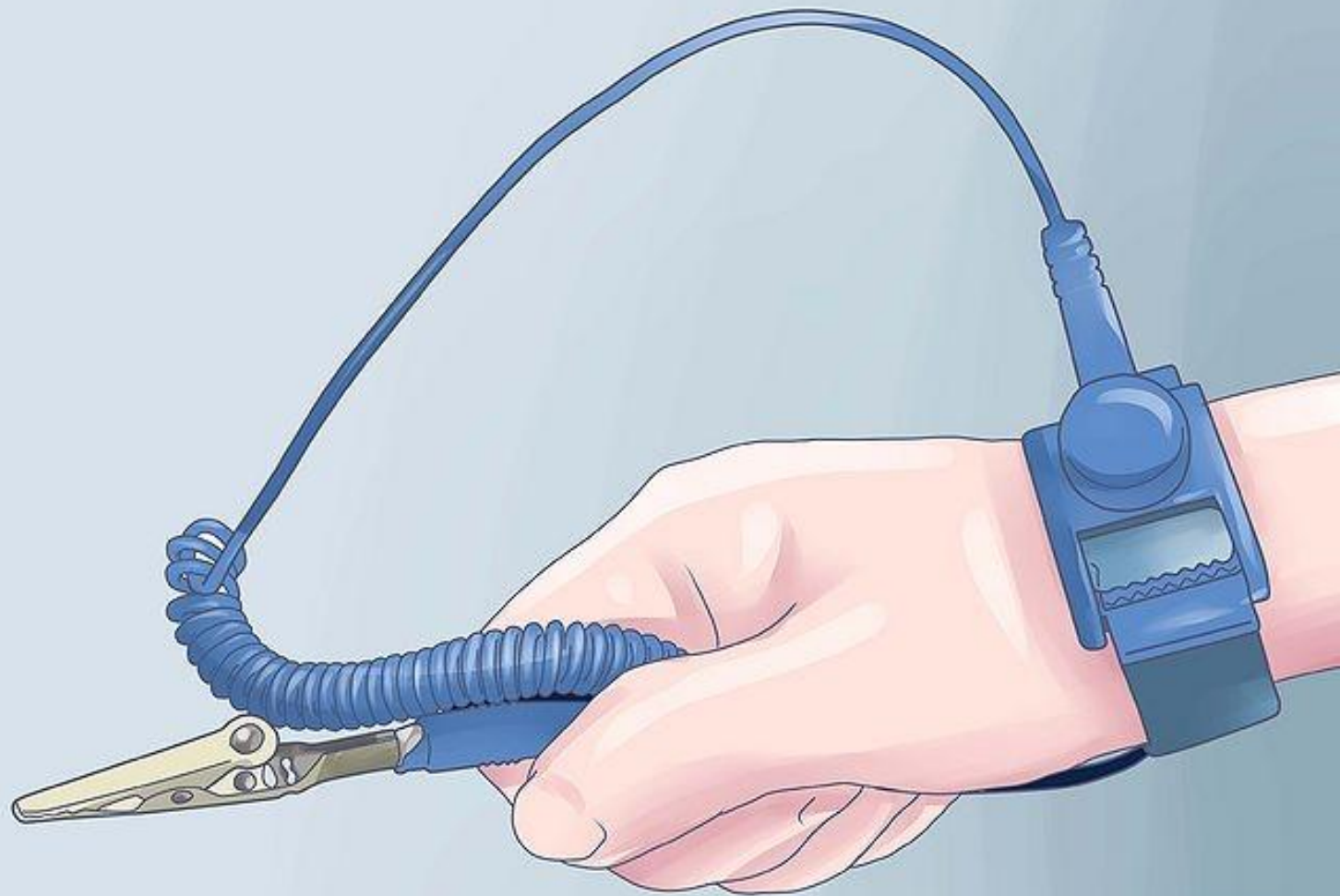

023

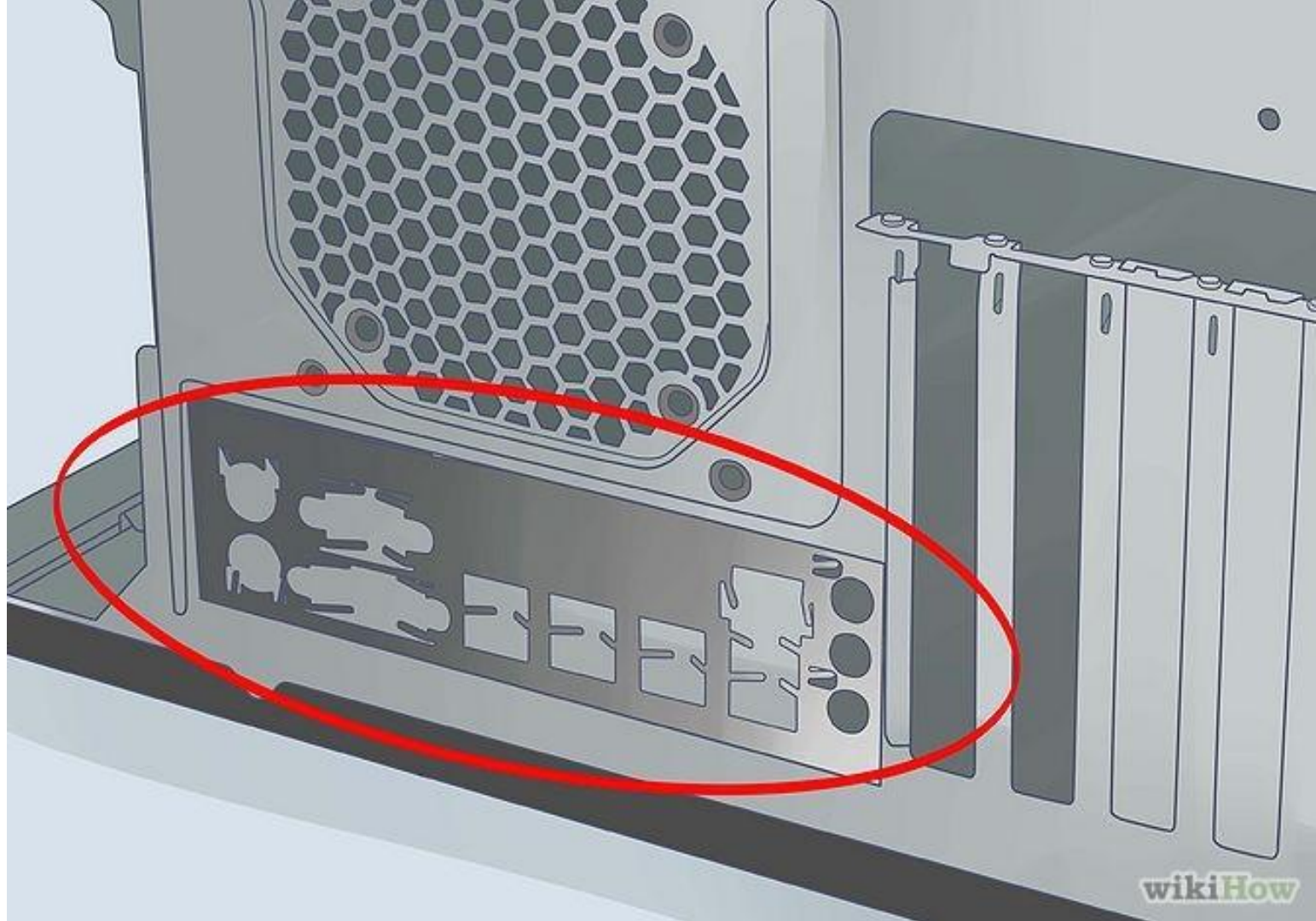

024

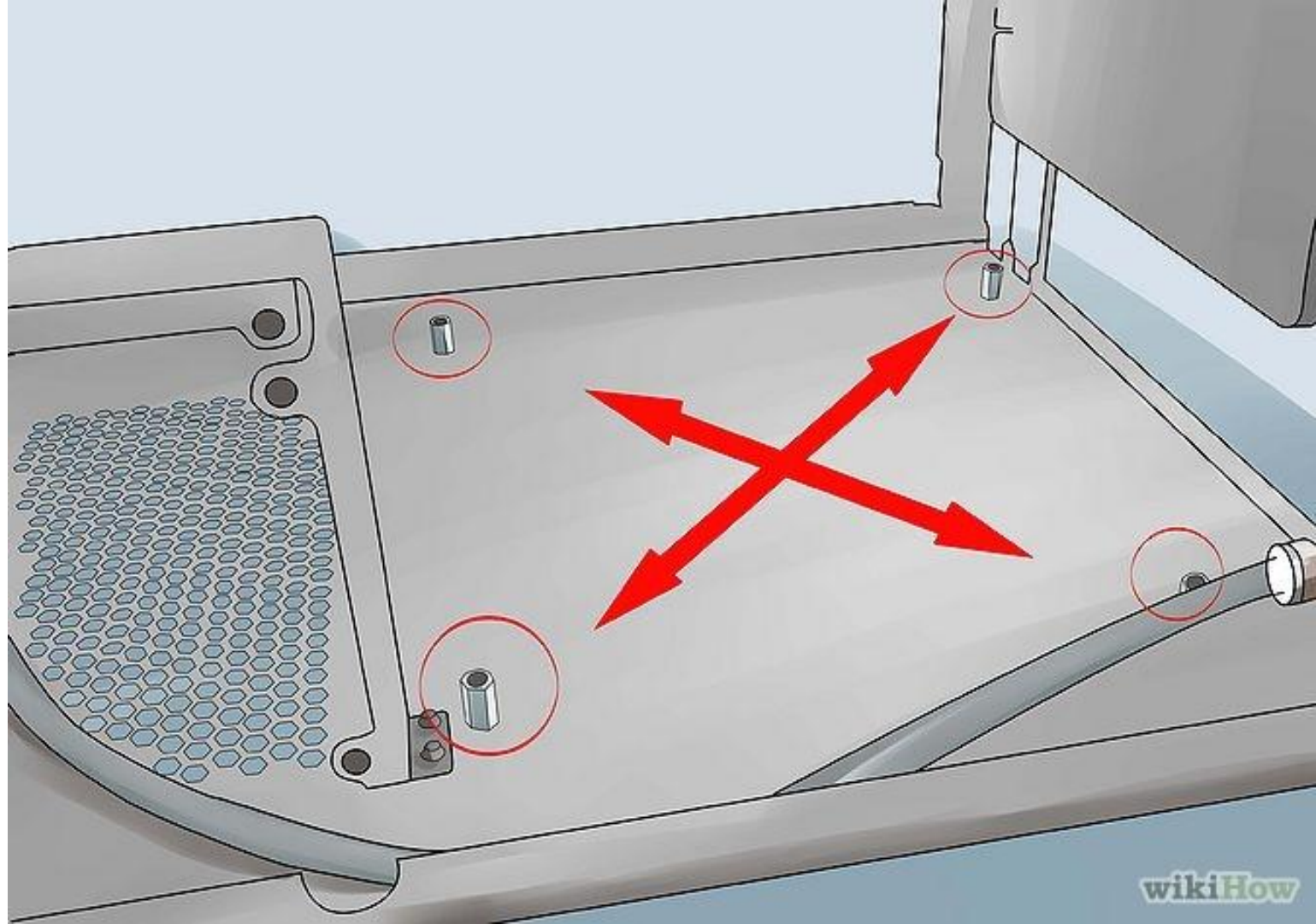

025

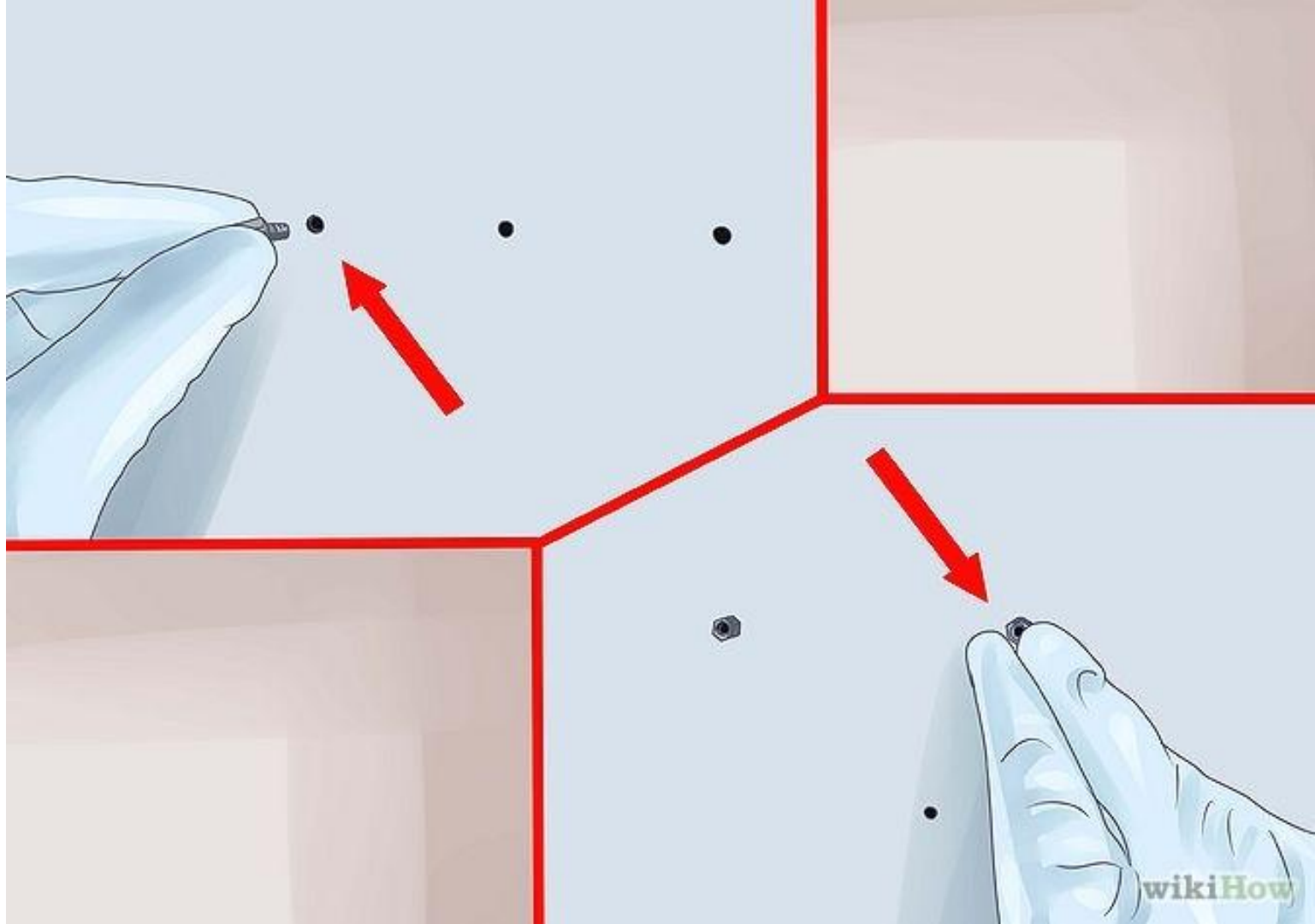

026

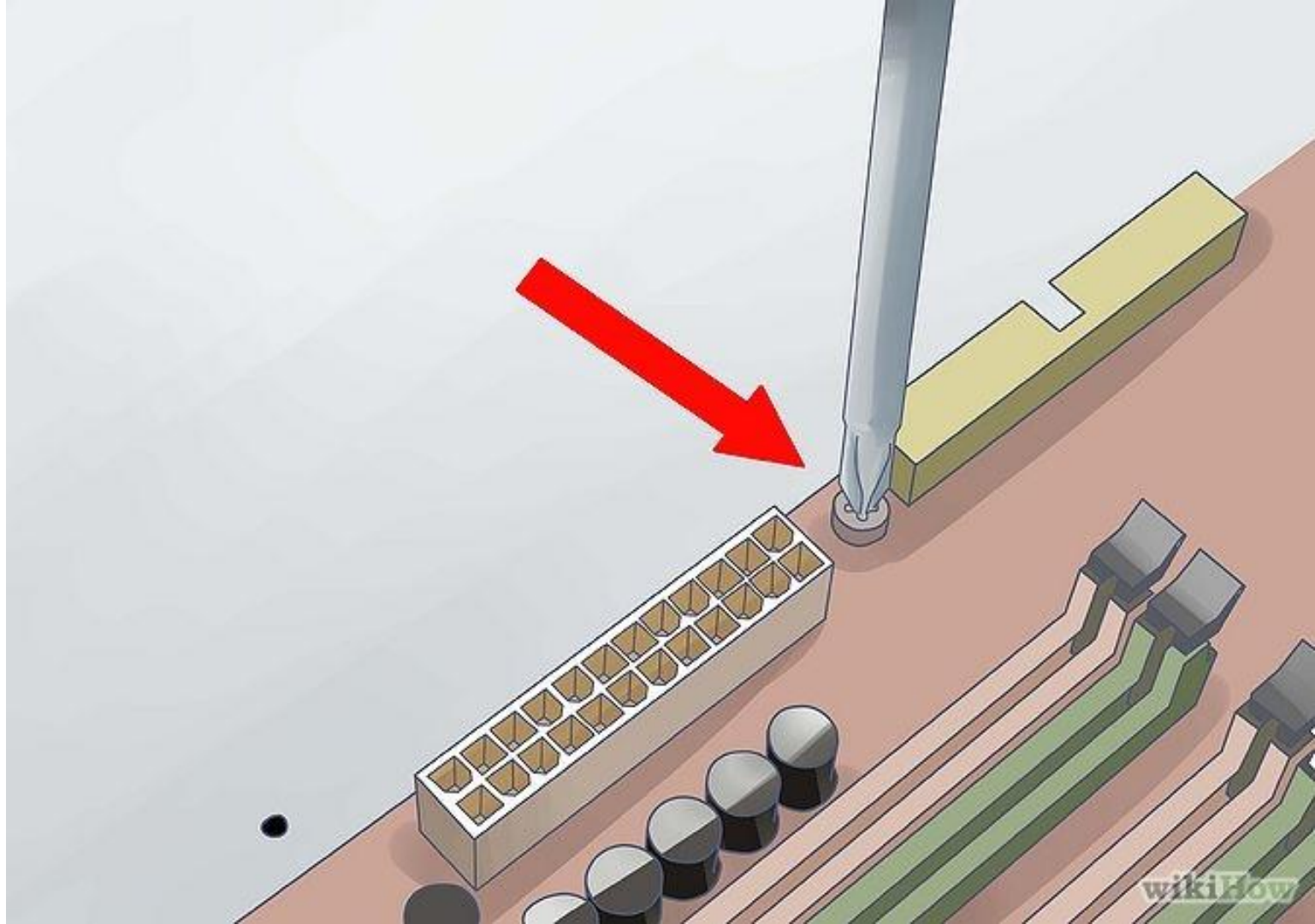

027

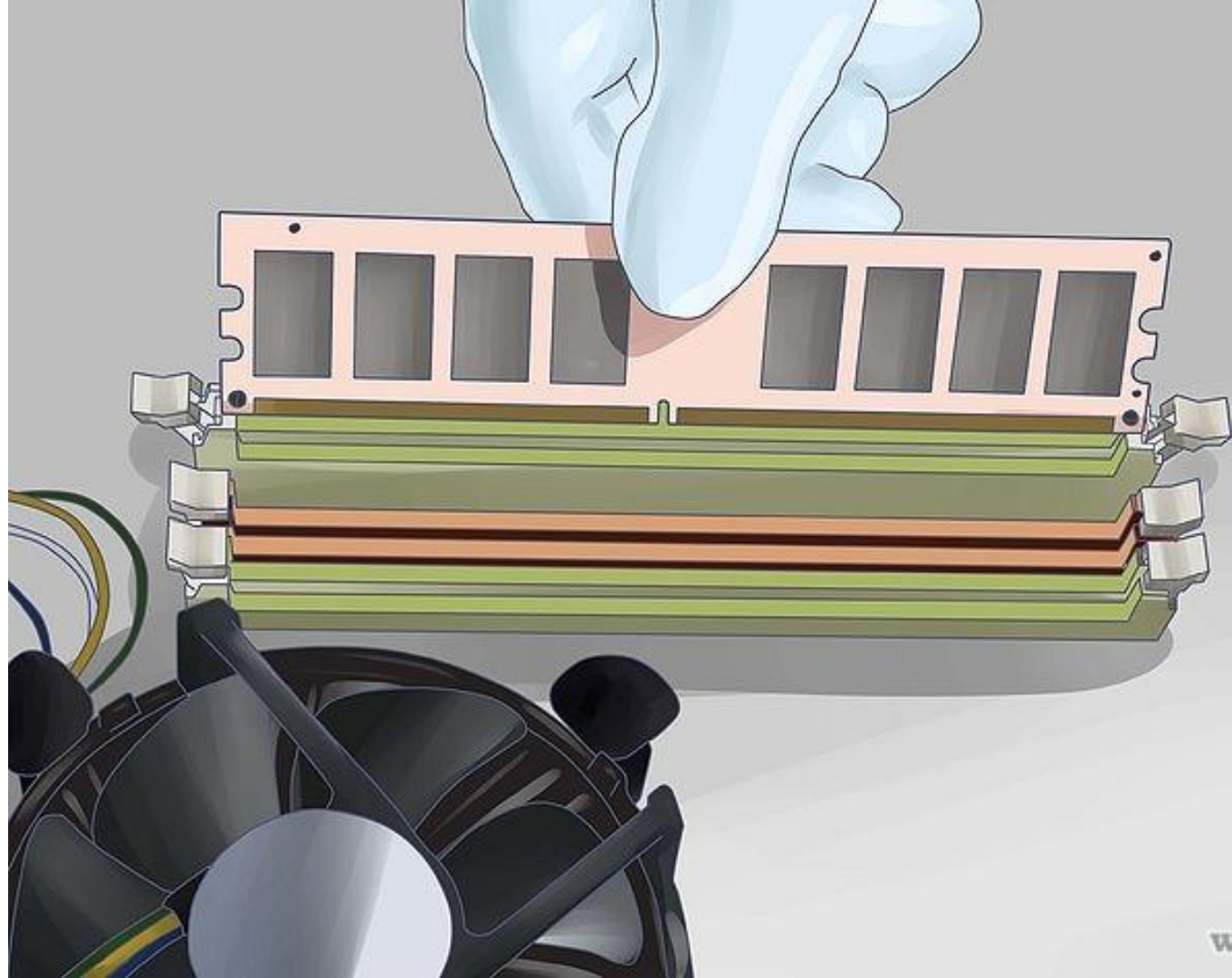

028

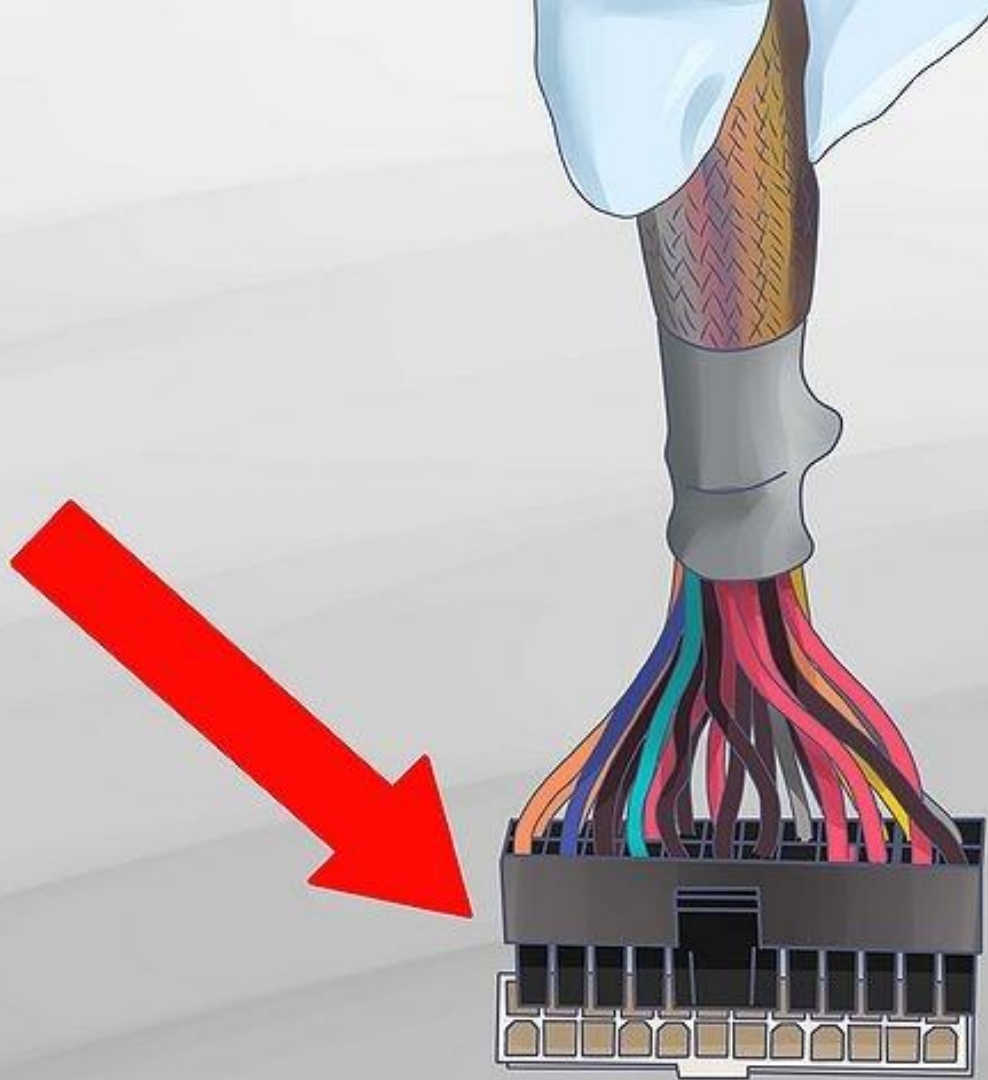

029

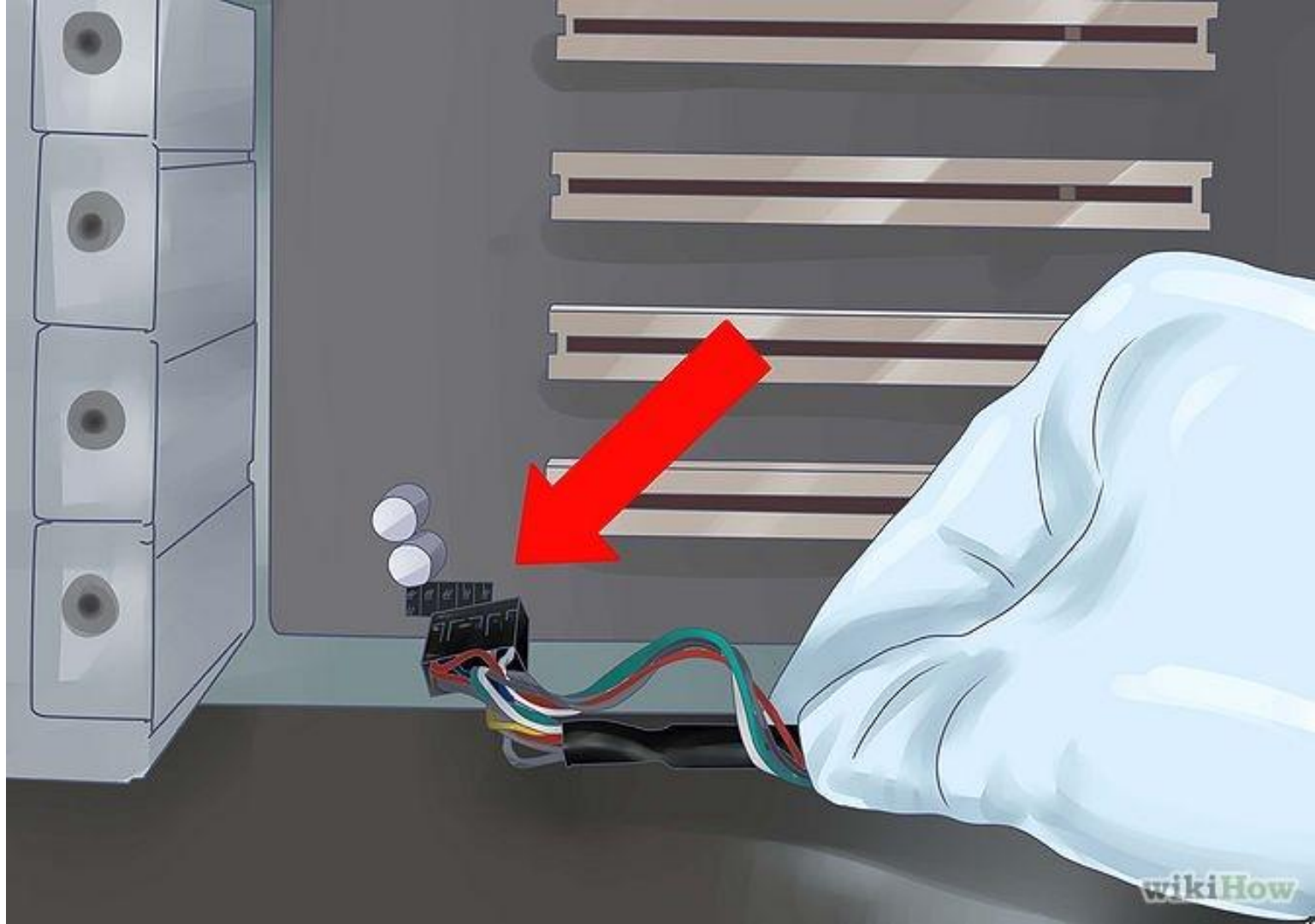

030

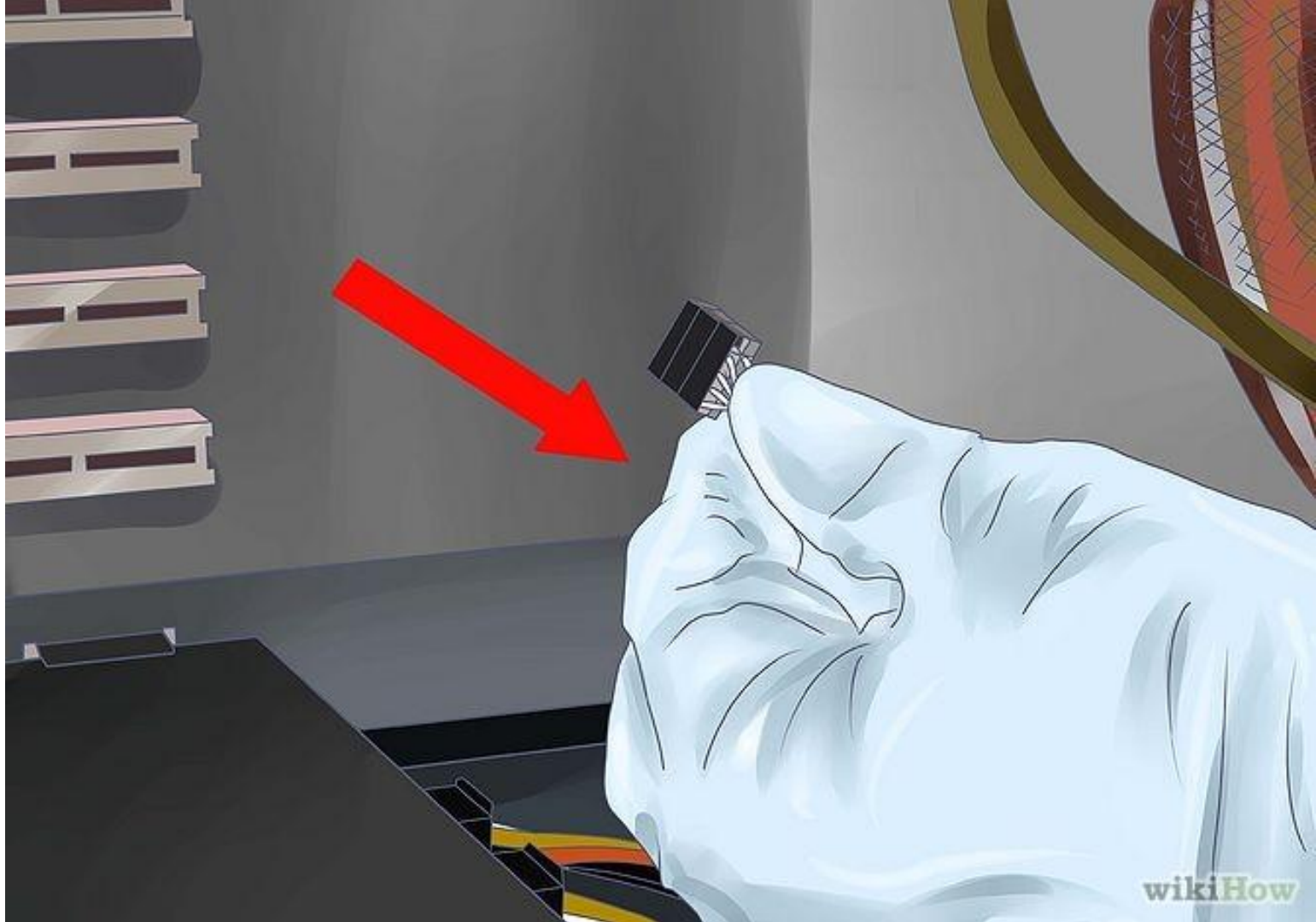

031

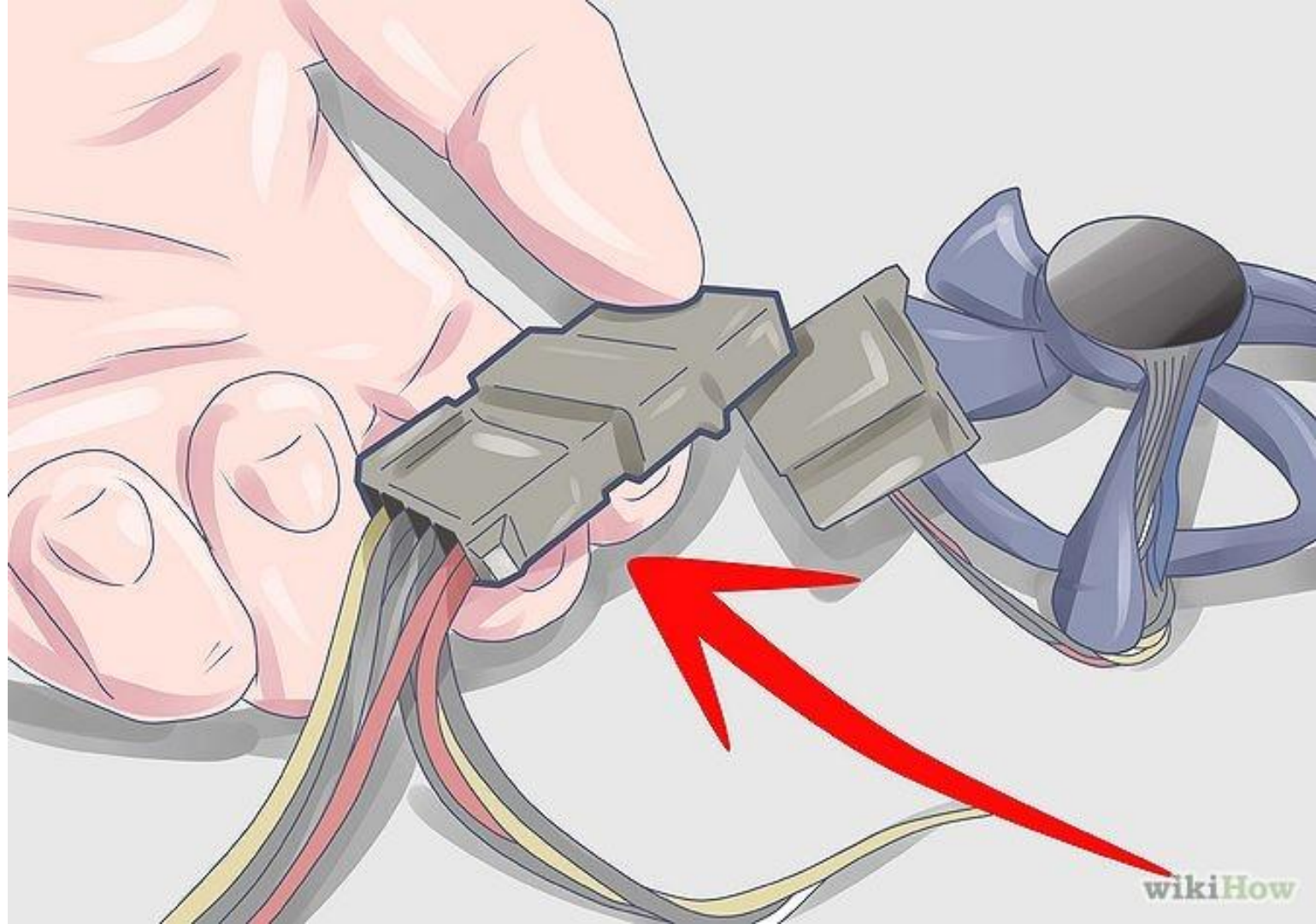

032

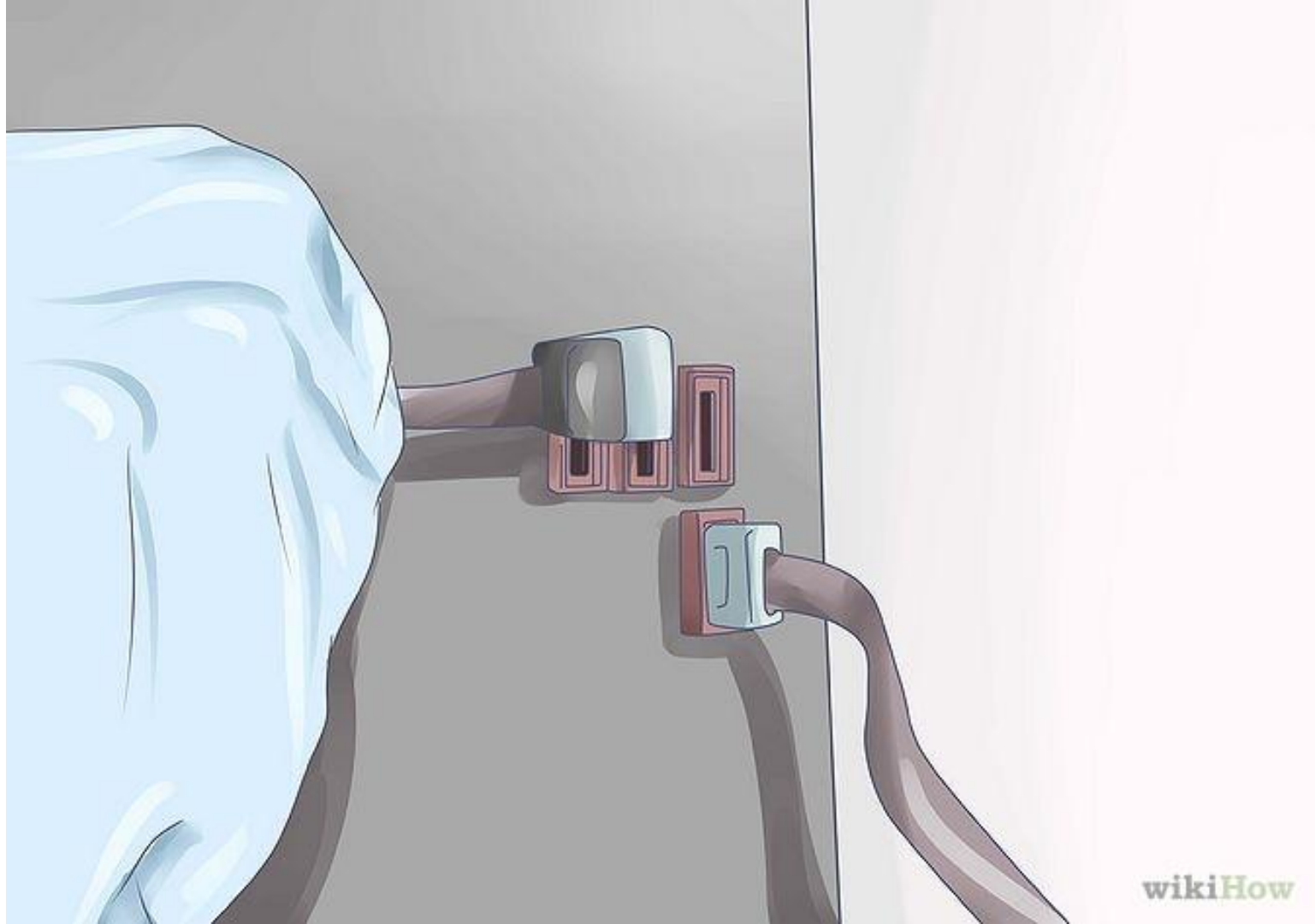

033

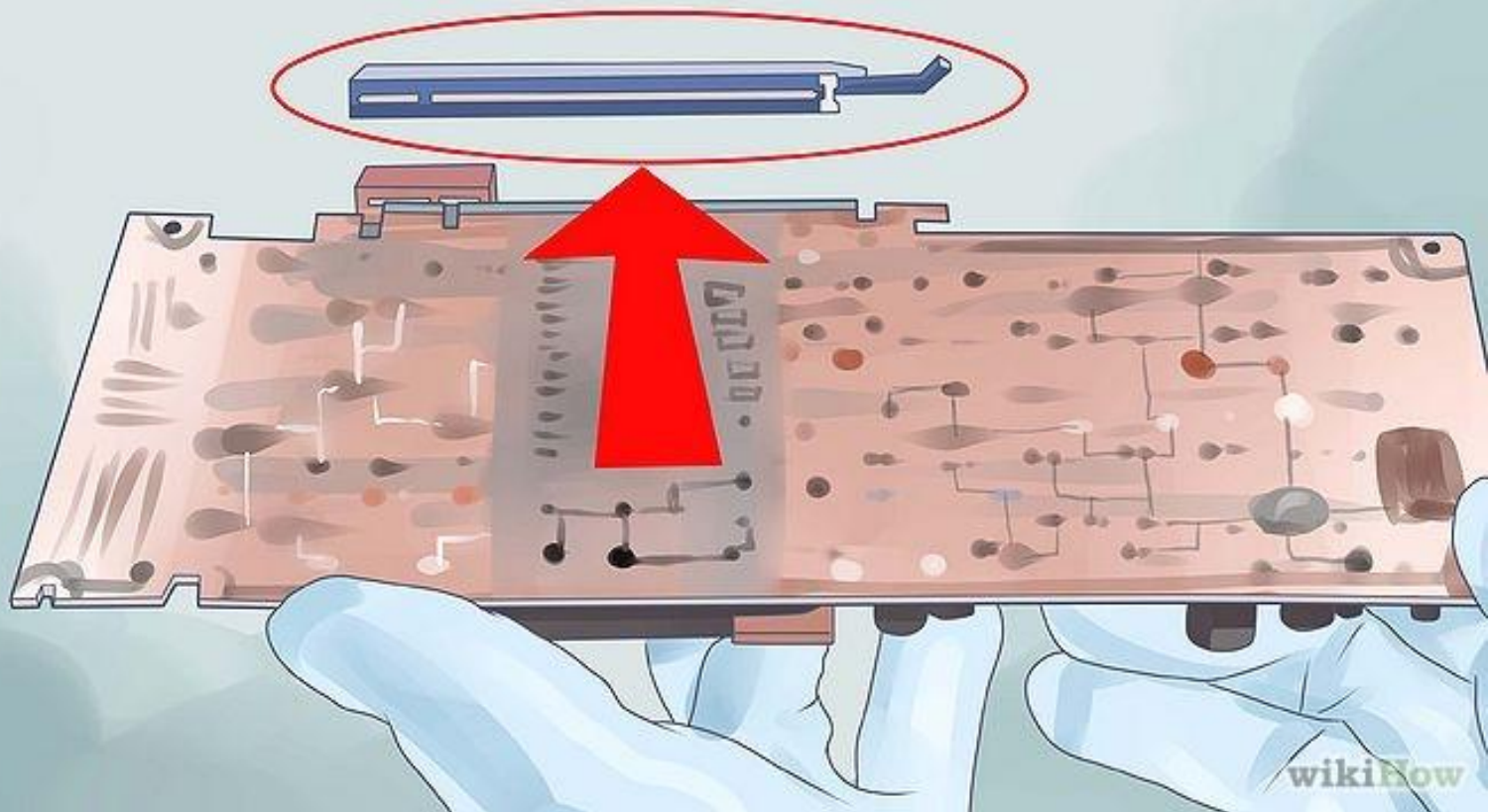

034

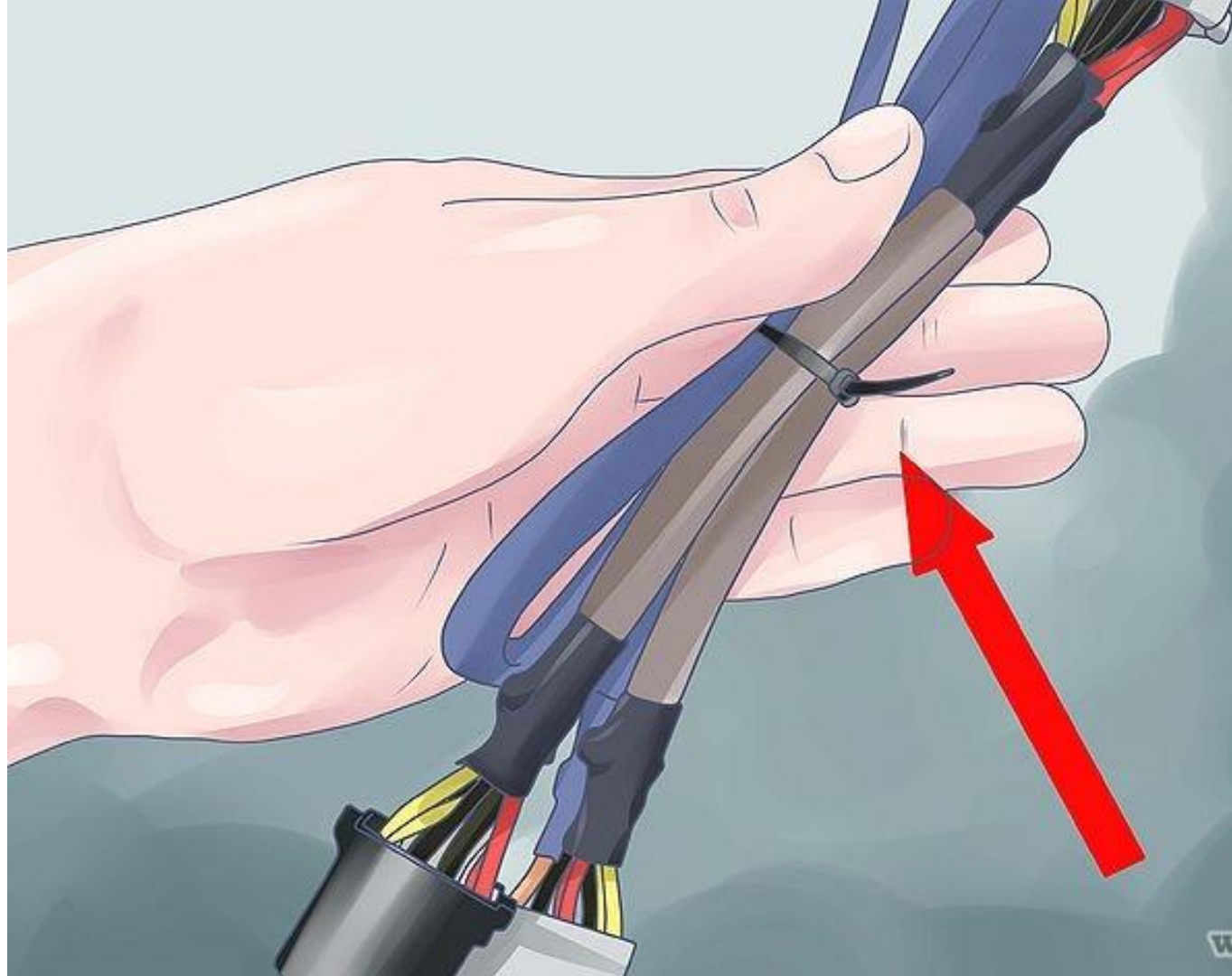



035