



# *passenger ships*

***Oasis of the Seas***

***MS Allure of the Seas***



# Oasis-class cruise ship

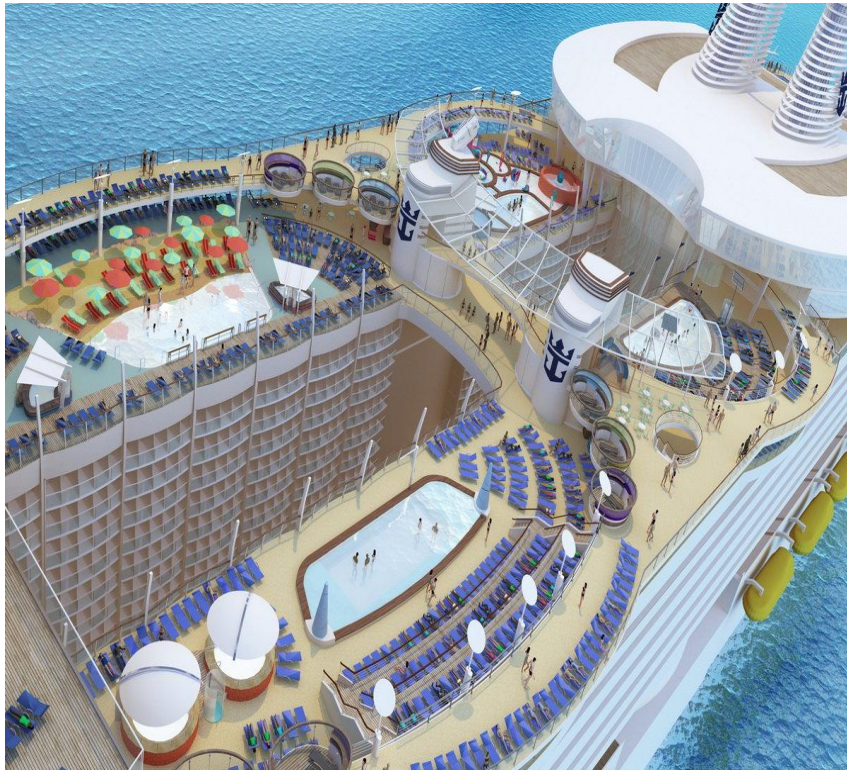

- **MS Oasis of the Seas** is an **Oasis-class cruise ship**, delivered to its owner, **Royal Caribbean International**, in October 2009. The first of her **class**, she was joined by her sister ship **MS Allure of the Seas** in December 2010. Both vessels cruise the Caribbean from **Port Everglades** in **Fort Lauderdale, Florida**. She set a new record of carrying over 6,000 passengers. <sup>[15]</sup>
- The ship surpassed the **Freedom-class** cruise ships (also owned by Royal Caribbean) to become the **largest cruise ship in the world** at that time. She has, however, since been surpassed by Allure of the Seas, which is 50 millimetres (2.0 in) longer, although this difference may have been caused by different temperatures when the measurements were made.

# Ship Features



- *The Oasis-class ships surpassed the earlier **Freedom-class** ships as the world's largest and longest passenger ships. Oasis also is 8.5 metres (28 ft) wider, and with a **gross tonnage** of 225,282, is almost 45% larger. Oasis-class vessels carry over 5,400 passengers.*

# General characteristics

- **Type:**
- **Cruise ship Tonnage:**
- **225,282 GT**
- **Length:**
- **360 m (1,181 ft) overall**
- **Beam:**
- **47 m (154 ft) waterline**
- **60.5 m (198 ft) extreme**
- **Height:**
- **72 m (236 ft) above water line**
- **Draught:**
- **9.3 m (31 ft)**
- **Depth:**
- **22.55 m (74 ft)**
- **Decks**
- **16 passenger decks**
- **Installed power:**
- **3 × Wärtsilä 12V46D engines (13,860 kW [ 18,590 hp ] each)**
- **3 × Wärtsilä 16V46D engines (18,480 kW [ 24,780 hp ] each)**
- **Propulsion:**
- **3 × 20 MW ABB Azipod, all azimuthing**
- **Speed:**
- **22.6 knots (41.9 km/h; 26.0 mph)**
- **Capacity:**
- **5,400 passengers double occupancy; 6,296 total**



# ***MS Allure of the Seas***



***MS Allure of the Seas is a cruise ship owned and operated by Royal Caribbean International. Together with her sister ship, Oasis of the Seas, she holds the record for the largest passenger ship ever constructed, although Allure is 50 millimetres (2.0 in) longer than Oasis, making her technically the largest despite the fact that both ships have identical superstructures. Designed under the name "Project Genesis", she was ordered from Aker Finnyards in February 2006 and her construction began at the Perno shipyard in Turku, Finland, in February 2008. She was named in May 2008 after a contest was held to name her and her sister. The keel of the Allure of the Seas was laid on 2 December 2008, shortly after the shipyard had been acquired by STX Europe.***

# Technical details



- The **gross tonnage** of the Allure is 225,282 and her **displacement** — the actual weight of the ship — is equal to that of the Oasis, which is estimated to be around 100,000 metric tons, slightly less than that of an American **Nimitz-class aircraft carrier**. Her steel hull alone weighs roughly 54,000 tons.



# General characteristics

---

- **Class & type:**
- **Oasis-class cruise ship Tonnage:**
- 225,282 **GT**
- 242,999 **NT**
- 19,750 **DWT**
- **Displacement:**
- **approximately 100,000 tons**
- **Length:**
- 362 m (1,187 ft)
- **Beam:**
- 47 m (154 ft) (waterline)
- 60.5 m (198 ft) (max moulded)
- 65 m (213 ft) (maximum beam)
- **Height:**
- 72 m (236 ft) above water line
- **Draught:**
- 9.3 m (31 ft)
- **Depth:**
- 22.5 m (74 ft)
- **Decks:**
- 16 passenger decks
- **Installed power:**
- 3 × 13,860 kW or 18,590 hp **Wärtsilä** 12V46D
- 3 × 18,480 kW or 24,780 hp **Wärtsilä** 16V46D
- **Propulsion:**
- 3 × 20 MW or 27,000 hp **ABB Azipod**
- 4 × 5.5 MW or 7,400 hp **Wärtsilä** CT3500 bow thrusters
- **Speed:**
- 22.6 knots (41.9 km/h; 26.0 mph)
- **Capacity:**
- 5,400 passengers at double occupancy
- 6,296 maximum
- **Crew:**
- 2,384 as of July 2012
- **Notes:**
- 50 mm (2.0 in) longer than Oasis



*source*

---

[http://en.wikipedia.org/wiki/MS Oasis of the Seas](http://en.wikipedia.org/wiki/MS_Oasis_of_the_Seas)

[http://en.wikipedia.org/wiki/MS Allure of the Seas](http://en.wikipedia.org/wiki/MS_Allure_of_the_Seas)