



Which item is missing?



Study the first slide for 30 seconds and try to see which item is missing in the second slide. Good luck!

#2

Study it!



Which item is missing





answer

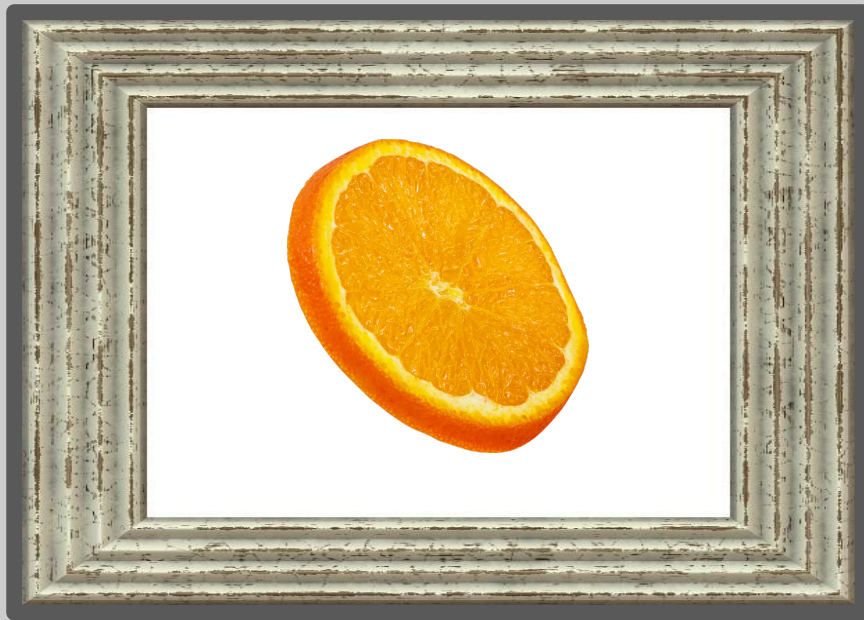

next game

Study it!



Which item is missing

A magnifying glass with a black handle and a silver rim is positioned over the word "item" in the text "Which item is missing". The magnifying glass is tilted slightly to the right, and its lens is centered over the word "item". The text is in a bold, black, sans-serif font.



answer



next game

Study it!



Which item is missing

A magnifying glass with a black handle and a silver rim is positioned over the word "item" in the text "Which item is missing". The magnifying glass is tilted slightly to the right, and its lens is centered over the word "item". The text is in a bold, black, sans-serif font.



answer

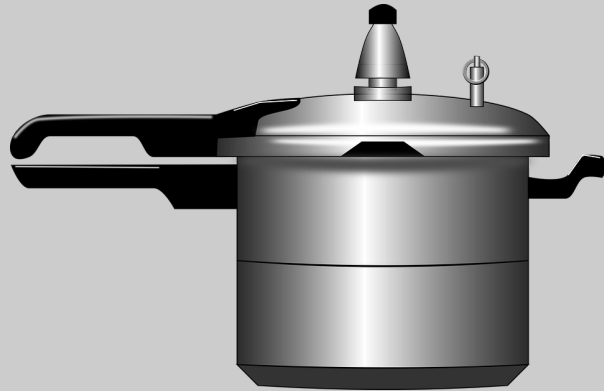

next game

Study it!



Which item is missing

A magnifying glass with a black handle and a silver rim is positioned over the word "item" in the text "Which item is missing". The magnifying glass is tilted slightly to the right, and its lens is centered over the word "item". The text is in a bold, black, sans-serif font.



answer



next game

Study it!

LOVE



Which item is missing

A magnifying glass with a black handle and a silver rim is positioned over the word 'item' in the text. The handle is angled downwards and to the right, and the lens is centered over the word 'item'.

LOVE



answer



next game

Study it!



Which item is missing





answer



next game

Study it!



Which item is missing





answer



next game

Study it!



Which item is missing





answer





great job!