

The 9th of November

Dialogue builder
Asking for directions

page 29

Dialogue builder

Asking for directions

1 Nikita and Chris are going to the Chamber of Horrors at Madame Tussauds. Look at the map and answer the questions.

- 1 What street is Madame Tussauds on?
- 2 What is the nearest tube station?
- 3 Which other places could Chris and Nikita visit nearby?

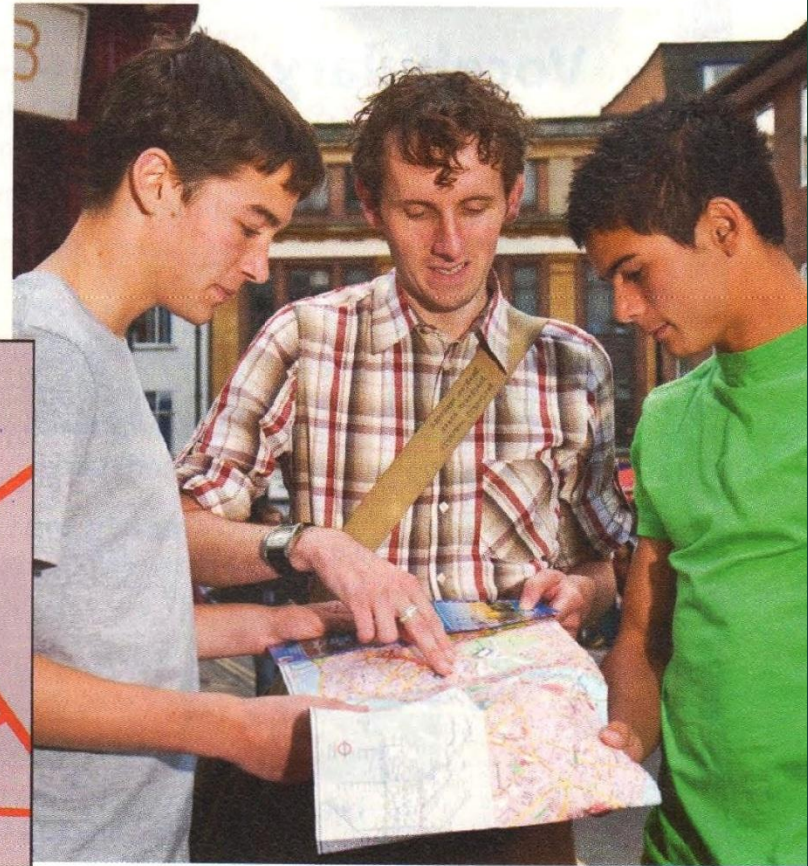
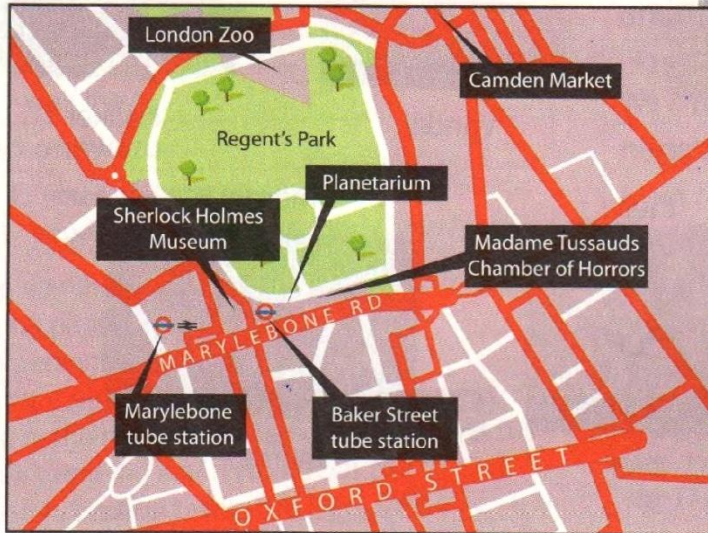

p.29 ex.2

- 2 **21** Chris lives in London, but he's a bit lost and is asking for directions. Listen and choose the correct answers.

Chris

Excuse me. I'm looking for Madame Tussauds. Is it near here?
What's the best way to go?

Straight on, then left?

Great. How far is it?

OK. Thanks very much.

Man

Yes, it's just down the road.

Go straight on here for about (1) **100 / 200** metres, then turn left on to Marylebone Road.

Yes, that's right. Madame Tussauds is on the (2) **right / left**, just after the Planetarium.

Oh, it isn't far. It'll take about (3) **five / ten** minutes to walk there.

No problem.

6  **22** Listen to Nikita asking for directions and answer the questions.

- 1 What is Nikita looking for?
- 2 Is it near?
- 3 How long will it take to walk there?

Useful expressions

I'm looking for ...
It's just down the road.
Go straight on. / Turn left / right.
Is it far? How far is it?

Dialogue builder

Asking for directions

- 1  11 Listen and complete the useful expressions.

Useful expressions

- 1 Hello, I'm the library.
- 2 It's the road.
- 3 How is it?
- 4 Go outside and right.
- 5 Go for 200 metres.
- 6 When you get to the toilets,
left.

2) It's Paul and Ellie's first day in their new school and they're lost. Complete the dialogue with these words.

far way lost right looking for turn how

Mr Granger Hello, are you (1)

Paul Yes! I'm a new student. I'm
(2) the sports hall.

Mr Granger It's outside, next to the car park.

Paul (3) far is it?

Mr Granger It isn't (4) at all. It's a
five-minute walk.

Paul What's the best (5)
to go?

Mr Granger Go outside and (6)
left. Walk past the science labs
and it's on the (7)

Paul Thanks!

Mr Granger No problem.

Paul Can you help my sister, too?

Mr Granger Yes, of course.

- 4) Ellie wants to get directions to the library. Look at the map and complete the dialogue with some of the useful expressions from exercise 1 and the words in brackets.

Mr Granger Hello, I'm Mr Granger.

Ellie I'm Ellie. I'm looking for the library.

Mr Granger (1).....
(outside / opposite the toilets)

Ellie How far is it?

Mr Granger (2).....
(not far / down the road)

Ellie What's the best way to go?

Mr Granger (3).....
(go outside / turn right / go straight on)

Ellie And then?

Mr Granger (4).....
(toilets / turn left)

Ellie Thanks!

Mr Granger No problem!

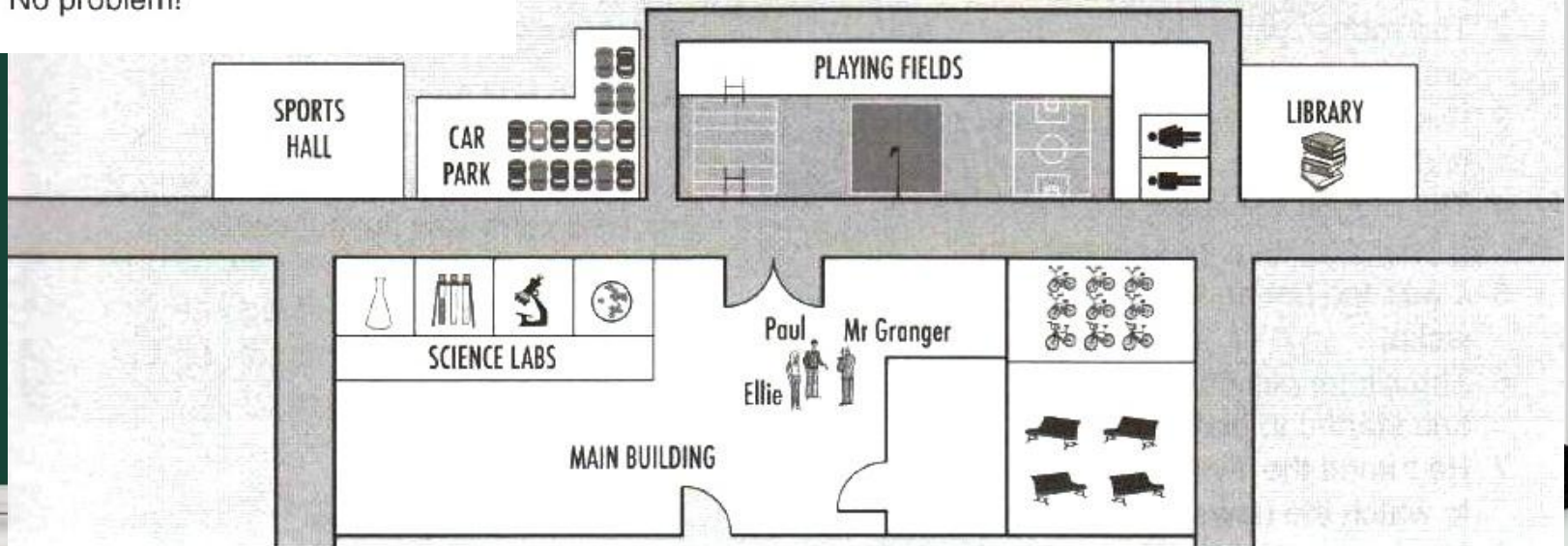

Homework

p. 29 ex. 4

4 Prepare a new dialogue. Imagine you are going to one of these places.

Oxford Street Sherlock Holmes Museum
a well-known place in your city